

vtech®

Parent's Guide

Go! Go!  
Smart Wheels®

Ramp It Up Dump Truck™



91-003862-001 US

# INTRODUCTION

Thank you for purchasing the **Go! Go! Smart Wheels® Ramp It Up Dump Truck™!**

Transform from a dump truck to a fun stunt ramp in seconds. Three light-up learning buttons introduce numbers and objects. Collect all the Go! Go! Smart Wheels® friends for even more fun!



## INCLUDED IN THIS PACKAGE

- Go! Go! Smart Wheels® Ramp It Up Dump Truck™
- 1 Mini Vehicle
- 2 Rock Accessories
- Parent's Guide

### WARNING

All packing materials such as tape, plastic sheets, packaging locks, removable tags, cable ties, cords and packaging screws are not part of this toy, and should be discarded for your child's safety.

### NOTE

Please keep this parent's guide as it contains important information.

Please cut and discard the strings that attach the vehicles to the unit before playing.

### ATTENTION

Pour la sécurité de votre enfant, débarrassez-vous de tous les produits d'emballage tels que rubans adhésifs, feuilles de plastique, attaches, étiquettes, cordons et vis d'emballage. Ils ne font pas partie du jouet.

### NOTE

Il est conseillé de conserver ce guide des parents car il comporte des informations importantes.

pour la sécurité de votre enfant, veuillez retirer la corde reliant la porte et la souris avant de le laisser jouer. Elle ne fait pas partie du jouet.

### Unlock the Packaging Locks

- ① Rotate the packaging locks 90 degrees counterclockwise.
- ② Pull out the packaging locks and discard.

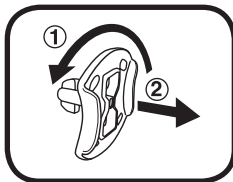

# GETTING STARTED

## Battery Removal and Installation

1. Make sure the unit is turned **Off**.
2. Find the battery cover on the bottom of the truck. Use a coin or a screwdriver to loosen the screw and open the battery cover.
3. Remove old batteries by pulling up on one end of each battery.
4. Install 2 new AAA (AM-4/LR03) batteries following the diagram inside the battery box.
5. Replace the battery cover and tighten the screw to secure.

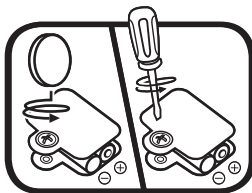

## BATTERY NOTICE

- Use new alkaline batteries for maximum performance.
- Use only batteries of the same or equivalent type as recommended.
- Do not mix different types of batteries: alkaline, standard (carbon-zinc) or rechargeable, or new and used batteries.
- Do not use damaged batteries.
- Insert batteries with the correct polarity (+ and -).
- Do not short-circuit the battery terminals.
- Remove exhausted batteries from the toy.
- Remove batteries during long periods of non-use.
- Do not dispose of batteries in fire.
- Do not charge non-rechargeable batteries.
- Remove rechargeable batteries from the toy before charging (if removable).
- Rechargeable batteries are only to be charged under adult supervision.

**DO NOT USE RECHARGEABLE BATTERIES.**

## PRODUCT FEATURES

### 1. Off/Low/High Volume Selector

To turn the unit **On**, slide the **Off/Low/High Volume Selector** to the Low (🔊) or High (🔊) position. You will hear a song, phrase and a playful sound. To turn the unit **Off**, slide the **Off/Low/High Volume Selector** to the **Off** (●) position.

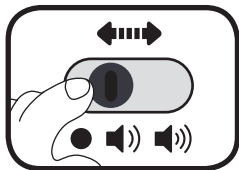

### 2. Automatic Shut-Off

To preserve battery life, the **Go! Go! Smart Wheels® Ramp It Up Dump Truck™** will automatically shut off after approximately 65 seconds without input. The unit can be turned on again by pressing the **Light-Up Buttons**, pulling the **Lever** or by pushing the dump truck quickly.

### NOTE

If the unit powers down automatically and repeatedly or the light fades out during playing, please install a new set of batteries.

## ACTIVITIES

### 1. Light-Up Buttons

Press the **Light-Up Buttons** to learn about numbers and objects. You will also hear playful songs, melodies and phrases. The lights will flash with the sounds.



### 2. Wheel Sensor

Push or pull the dump truck to hear playful sounds and tunes. When a melody is playing, push or pull the dump truck to add fun sounds on top of the melody. The lights will flash with the sounds.



3. **Lever**

Pull the **Lever** to hear playful sounds and tunes. The lights will flash with the sounds.

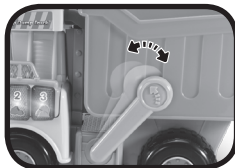

4. **Dump Truck Bucket**

Fill up the dump truck **Bucket** with the two included **Rocks**, then pull the **Lever** to tip the **Bucket** and unload the cargo.



5. **Stunt Ramp**

Slide the lock to the right to unlock, flip up the **Handle**, then flip the **Bucket** of the truck down to transform it into a **Stunt Ramp**. Pull the **Lever** to lift up the platform to launch a vehicle down the ramp.

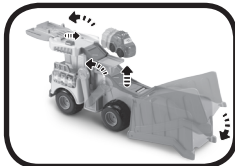

6. **Mini Vehicle Play**

Use the **Mini Vehicle** to zip down the **Stunt Ramp**.

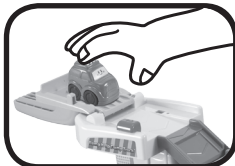

7. **SmartPoint® Location**

When the **Stunt Ramp** is unfolded, the **SmartPoint®** location is accessible. Place any **SmartPoint®** vehicle (each sold separately) on the **SmartPoint®** location to trigger fun sounds, short tunes or phrases.



## NOTE

If the **Bucket** becomes detached from the dump truck, line up the attachment points and then slide the **Bucket** back onto the T-pins (see below). You will hear it click into place.



## SONG LYRICS

### Song 1

Load the rocks and hit the road.  
To and fro and then unload.

### Song 2

It is time to work at the construction site.  
Come with me, from site to site, all day and night.

### Song 3

Go! Go! Smart Wheels!  
Go! Go! Smart Wheels!  
I'm a Go! Go! Smart Wheels dump truck,  
Moving over the road. (Go! Go!)  
Loading and unloading, I never feel tired.  
Let's Go! Go! and see! (Go! Go!)

## MELODY LIST

1. Turkey in the Straw
2. Three Blind Mice
3. Shoo Fly
4. Old King Cole
5. London Bridge
6. Pop! Goes the Weasel
7. She'll Be Coming 'Round the Mountain
8. This Old Man
9. Skip to My Lou

## CARE & MAINTENANCE

1. Keep the unit clean by wiping it with a slightly damp cloth.
2. Keep the unit out of direct sunlight and away from any direct heat source.
3. Remove the batteries when the unit will not be in use for an extended period of time.
4. Do not drop the unit on hard surfaces and do not expose the unit to moisture or water.

## TROUBLESHOOTING

If for some reason the unit stops working or malfunctions, please follow these steps:

1. Please turn the unit **Off**.
2. Interrupt the power supply by removing the batteries.
3. Let the unit sit for a few minutes, then replace the batteries.
4. Turn the unit **On**. The unit should now be ready to play again.
5. If the unit still does not work, install a new set of batteries.







## IMPORTANT NOTE

If the problem persists, please call our **Consumer Services Department** at **1-800-521-2010** in the U.S., **1-877-352-8697** in Canada, or visit our website **vtechkids.com** and fill out our **Contact Us** form located under the **Customer Support** link. Creating and developing VTech products is accompanied by a responsibility that we take very seriously. We make every effort to ensure the accuracy of the information, which forms the value of our products. However, errors sometimes can occur. It is important for you to know that we stand behind our products and encourage you to contact us with any problems and/or suggestions you might have. A service representative will be happy to help you.

## CAUTION



Changes or modifications not expressly approved by the party responsible for compliance could void the user's authority to operate the equipment.



## NOTE

This equipment has been tested and found to comply with the limits for a Class B digital device, pursuant to Part 15 of the FCC Rules. These limits are designed to provide reasonable protection against harmful interference in a residential installation. This equipment generates, uses and can radiate radio frequency energy and, if not installed and used in accordance with the instructions, may cause harmful interference to radio communications. However, there is no guarantee that interference will not occur in a particular installation. If this equipment does cause harmful interference to radio or television reception, which can be determined by turning the equipment off and on, the user is encouraged to try to correct the interference by one or more of the following measures:

- Reorient or relocate the receiving antenna.
- Increase the separation between the equipment and receiver.
- Connect the equipment into an outlet on a circuit different from that to which the receiver is connected.
- Consult the dealer or an experienced radio/TV technician for help.

### **Supplier's Declaration of Conformity**

#### **47 CFR § 2.1077 Compliance Information**

Trade Name: VTech®  
Model: 5351  
Product Name: Go! Go! Smart Wheels® Ramp It Up  
Dump Truck™  
Responsible Party: VTech Electronics North America, LLC  
Address: 1156 W. Shure Drive, Suite 200,  
Arlington Heights, IL 60004  
Website: vtechkids.com

THIS DEVICE COMPLIES WITH PART 15 OF THE FCC RULES. OPERATION IS SUBJECT TO THE FOLLOWING TWO CONDITIONS: (1) THIS DEVICE MAY NOT CAUSE HARMFUL INTERFERENCE, AND (2) THIS DEVICE MUST ACCEPT ANY INTERFERENCE RECEIVED, INCLUDING INTERFERENCE THAT MAY CAUSE UNDESIRE OPERATION.

***CAN ICES-3 (B)/NMB-3(B)***



**Visit our website for more  
information about our products,  
downloads, resources and more.**

***www.vtechkids.com***  
***www.vtechkids.ca***

Read our complete warranty policy online at  
***www.vtechkids.com/warranty***  
***www.vtechkids.ca/warranty***



TM & © 2020 VTech Holdings Limited.  
All rights reserved.  
**Printed in China.**  
91-003862-001 ©